

## 62300 Series

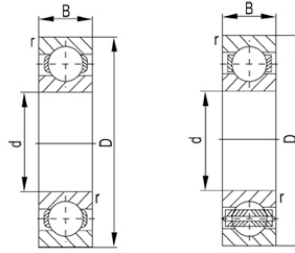

轴承编号	轴承	外形尺寸 (mm)			基本额定载荷 (kN)		质量 Kg
		d	D	B	rs min	动 (Cr)	
62301		12	37	17	-	-	-
62302		15	42	17	-	-	-
62303		17	47	19	-	-	-
62304		20	52	21	-	-	-
62305		25	62	24	-	-	-
62306		30	72	27	-	-	-
62307		35	80	31	-	-	-
62308		40	90	33	-	-	-
62309		45	100	36	-	-	-
62310		50	110	40	-	-	-