

16000 Series

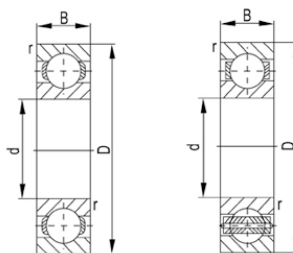

| Bearing No. | Boundary dimensions [mm] | | | | Basic load ratings(kN) | | Limiting speed(rpm) | | Mass Kg |
|-------------|--------------------------|-----|----|--------|------------------------|-------------|---------------------|-------|---------|
| | d | D | B | rs min | Dynamic(Cr) | Static(Cor) | Grease | Oil | |
| 16001 | 12 | 28 | 7 | 0.3 | 5.1 | 2.39 | 26000 | 30000 | 0.019 |
| 16002 | 15 | 32 | 8 | 0.3 | 5.6 | 2.83 | 22000 | 26000 | 0.025 |
| 16003 | 17 | 35 | 8 | 0.3 | 6.8 | 3.35 | 20000 | 24000 | 0.032 |
| 16004 | 20 | 42 | 8 | 0.3 | 7.9 | 4.5 | 18000 | 21000 | 0.051 |
| 16005 | 25 | 47 | 8 | 0.3 | 8.35 | 5.1 | 15000 | 18000 | 0.06 |
| 16006 | 30 | 55 | 9 | 0.3 | 11.2 | 7.35 | 13000 | 15000 | 0.091 |
| 16007 | 35 | 62 | 9 | 0.3 | 11.7 | 8.2 | 12000 | 14000 | 0.11 |
| 16008 | 40 | 68 | 9 | 0.3 | 12.6 | 9.65 | 10000 | 12000 | 0.125 |
| 16009 | 45 | 75 | 10 | 0.6 | 12.9 | 10.5 | 9200 | 11000 | 0.171 |
| 16010 | 50 | 80 | 10 | 0.6 | 13.2 | 11.3 | 8400 | 9800 | 0.18 |
| 16011 | 55 | 90 | 11 | 0.6 | 18.6 | 15.3 | 7700 | 9000 | 0.258 |
| 16012 | 60 | 95 | 11 | 0.6 | 20 | 17.5 | 7000 | 8300 | 0.283 |
| 16013 | 65 | 100 | 11 | 0.6 | 20.5 | 18.7 | 6500 | 7700 | 0.307 |
| 16014 | 70 | 110 | 13 | 0.6 | 24.4 | 22.6 | 6100 | 7100 | 0.441 |
| 16015 | 75 | 115 | 13 | 0.6 | 25 | 24 | 5700 | 6700 | 0.464 |
| 16016 | 80 | 125 | 14 | 0.6 | 25.4 | 25.1 | 5300 | 6200 | 0.597 |
| 16017 | 85 | 130 | 14 | 0.6 | 25.9 | 26.2 | 5000 | 5900 | 0.626 |
| 16018 | 90 | 140 | 16 | 1 | 33.5 | 33.5 | 4700 | 5600 | 0.848 |
| 16019 | 95 | 145 | 16 | 1 | 34.5 | 35 | 4500 | 5300 | 0.885 |
| 16020 | 100 | 150 | 16 | 1 | 35 | 36.5 | 4200 | 5000 | 0.91 |
| 16021 | 105 | 160 | 18 | 1 | 52 | 50.5 | 4000 | 4700 | 1.2 |
| 16022 | 110 | 170 | 19 | 1 | 57.5 | 56.5 | 3800 | 4500 | 1.46 |

16000 Series

| | | | | | | | | | |
|-------|-----|-----|----|-----|------|------|------|------|------|
| 16024 | 120 | 180 | 19 | 1 | 63 | 63.5 | 3500 | 4100 | 1.56 |
| 16026 | 130 | 200 | 22 | 1.1 | 80 | 79.5 | 3200 | 3800 | 2.31 |
| 16028 | 140 | 210 | 22 | 1.1 | 82 | 85 | 3000 | 3500 | 2.45 |
| 16030 | 150 | 225 | 24 | 1.1 | 96.5 | 101 | 2800 | 3200 | 3.07 |
| 16032 | 160 | 240 | 25 | 1.5 | 99 | 108 | 2600 | 3000 | 3.64 |
| 16034 | 170 | 260 | 28 | 1.5 | 119 | 128 | 2400 | 2800 | 4.93 |
| 16036 | 180 | 280 | 31 | 2 | 117 | 134 | 2300 | 2700 | 6.49 |
| 16038 | 190 | 290 | 31 | 2 | 134 | 156 | 2100 | 2500 | 6.77 |