

Single Row Inch Size

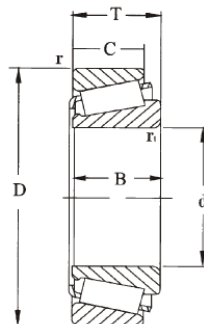

Bearing No.	Boundary dimensions [mm]							Basic load ratings(kN)	
	d	B	R	D	C	r	T	Dynamic(Cr)	Static(Cor)
1380	22.225	20.168	1.5						
1380/28	22.225	20.168	1.5	52.388	14.288	1.5	19.368	40.5	43
14117A/276	30	19.583	1.3	69.012	15.875	3.5	19.845	48.5	58
14125A	31.75	19.583	1.3						
14137A	34.925	19.583	1.3						
14137A/276	34.925	19.583	1.3	69.012	15.875	1.5	19.845	48.5	58
14276				69.012	15.875	1.3			
15100	25.4	20.638	1.3						
15100/245	25.4	20.638	1.3	62	14.288	3.5	19.05	46.5	54
15101	25.4	20.638	2						
15101/243	25.4	20.638	2	61.912	14.288	0.8	19.05	46.5	54
15103	26.157	20.638	1.3						
15103/245	26.157	20.638	1.3	62	14.288	0.8	19.05	46.5	54
15106	26.988	20.638	1.3						
15106/245	26.988	20.638	1.3	62	14.288	0.8	19.05	46.5	54
15123	31.75	19.05	1.3						
15123/245	31.75	19.05	1.3	62	14.288		18.161	46.5	54
15125	31.75	20.638	1.3						
15125/245	31.75	20.638	1.3	62	14.288	3.5	19.05	46.5	54
15126	31.75	20.638	1.3						
15126/245	31.75	20.638	1.3	62	14.288	0.8	19.05	46.5	54
15243				61.912	14.288	0.8			

Single Row Inch Size

15245				62	14.288	0.8			
1780	25.4	19.837	1.3						
18520				73.025	12.7	3.5			
18590	41.275	17.462	1.5						
18590/20	41.275	17.462	1.5	73.025	12.7	3.5	16.667	46	55.5
18620				79.375	13.495	2.8			
18690	46.038	17.462	1.5						
18720				85	13.495	3.5			